

Foreward

Thank you for choosing TUR-6200 Turbidity Data Acquisition Terminal !

Please read this introduction carefully before installation, correct installation and parameter setting will use the performance and advantage of the product in the best way, bringing you a good using experience.

This instrument is a precision process analysis and control instrument, and it should be installed, operated and repaired by trained personnel or other personnel who understand and grasp this professional knowledge.

If you meet some difficulties in the process of the installation and using, please inquire Technical Support Department in time.

After unpacking, please be sure to check the complete set of list and the actual product you received, if there is anything missing or damaged, please contact in time.

The manufacturer promises seriously:

1. If quality problems appear within one year from the date of purchase, you will receive free product repair or replacement of a new instrument.

2. No matter in what way you get this product, manufacturer provides eternal technical maintenance as a promise for the sold instruments.

3. Damages to the product caused by the following reasons are not within the scope of the warranty:

a) Misconnection with high voltage power source or damage caused by flooding;

b) Damage caused by privately refitting and improper use;

c) Collateral damage because of the improper selection of model;

d) Damage caused by going beyond the using conditions of the product;

e) All physical damage caused by the improper pressure;

f) Failure appears because storage and transportation are not in accordance with the stipulations of storage or transportation conditions (reference standard SJ/T10463-93);

g) Consumable materials need to purchase separately.



When this symbol appears in the manual, it means that something about safety, installation, product function and using should be paid special attention!

Keep pace with the times is the rule of the enterprise development, there will be periodical upgrade of products, and we will not have further notice on general changes, please in kind prevail.

Content

I. General Introduction.....	1
II. Product Naming Standard.....	1
III. Characteristics.....	2
IV. Application.....	2
V. Main Features.....	4
VI. Dimension and wiring connection.....	6
VII. Installation and maintenance instructions.....	8
VIII. Daily maintenance and precautions of the sensor.....	19
IX. Product completeness.....	20
(1) Standard package.....	20
(2) Communication conversion accessories (optional).....	21
(3) Display unit (optional).....	23
(4) Product Installation accessories (optional).....	24
(5) calibration accessories (optional).....	24
(6) Connector (optional).....	25
X. Appendix 1: RS485-Modbus.....	25

I. General Introduction

TUR-6200 is a digital high turbidity data acquisition terminal with RS485 output itself. It has below features like RS485 output , optical maintenance scraping device, circular timing, appointment timing cleaning.

It can be directly connected with IPC, configuration display, PLC, digital instrument, wireless communication module, data acquisition instrument and any other communication equipment conforming to Modbus RTU format to constitute a collection system.

It is widely used in environmental protection water treatment, waterworks process, water source or hydrological monitoring.



1.1 TUR-6200 Appearance of High Turbidity Data Acquisition Terminal

II. Product Naming Standard

A full range of Turbidity series, naming as below :

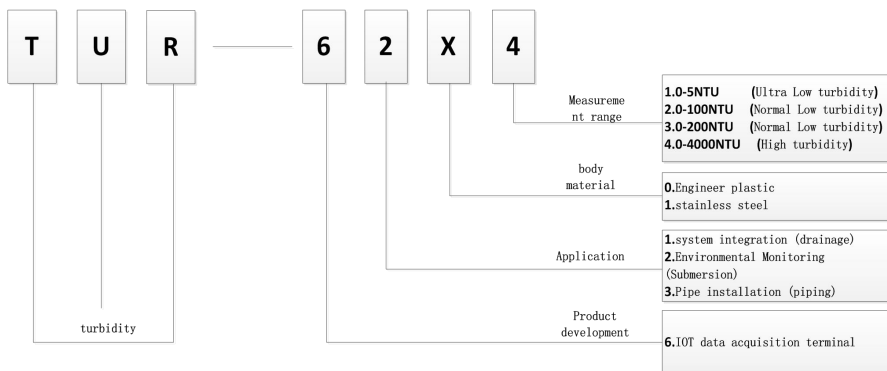

III. Characteristics

- ✧ optical turbidity measurement conforms to the international ISO7027-1999 standard;
- ✧ RS485 communication interface with Modbus RTU Protocol;
- ✧ workable with any IPC, digital interface, PLC and wireless data module system;
- ✧ Different measurement unit for selection to meet different country standard;
- ✧ With electronic zero and standard liquid calibration function;
- ✧ With such functions like optical maintenance scraping device, circular timing, appointment timing cleaning;
- ✧ Power supply DC9-28V, non - polarity connection, automatic default wiring anti-stalling function;
- ✧ Direct output digital signal, no transmission distortion, transmission distance, strong anti-interference ability;
- ✧ Good electromagnetic compatibility (EMC) design

IV. Application

- ✧ Directly as data acquisition terminal of the industrial site DCS and PLC system ;
- ✧ Entering cloud communication and Big data platform through DTU of GPRS;
- ✧ Wifi module as nearby wireless data acquisition terminal ;
- ✧ Remote wireless data acquisition terminal by Zigbee / Lora
- ✧ Optical remote data acquisition can be realized y optical terminal and far infrared terminal ;

- ◇ Supporting traditional 4-20mA industrial system (cable end RS485/4-20mA) module conversion;
- ◇ With a variety of 485/WiFi/USB tool converter, you can achieve calibration, address search, baud rate search and configuration by APP



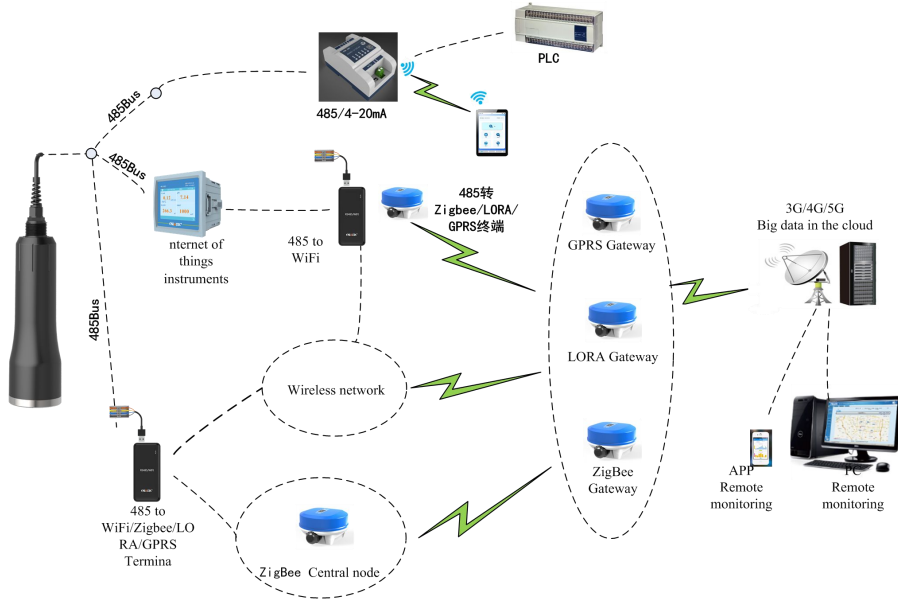

4.1 Different display mode of data acquisition terminal



4.2 Connection diagram

V. Main Features

Model	TUR-6204	TUR-6214
Picture		
Measurement Range	(1-4000) NTU	(0.1-4000) NTU
Measurement Parameter	Turbidity	
Light source	850nm (infrared light)	
Solution	<10NTU, 0.001NTU	
	<100NTU, 0.01NTU	
	<1000NTU, 0.1NTU	
	<4000NTU, 1NTU	
Accuracy	(0-100) NTU: less than reading 5% or 0.5NTU	
	(100-1000) NTU: ±2.5%FS	
	(1000-4000) NTU±2.5%FS	

TUR-6200 Turbidity Data Acquisition Terminal

Repeatability	<3%	
Water sample Flow	<3m/s	
Maintenance	Auto wiper with cycle setting function	
Working Environment	Temp: (0~50) °C ; Humidity: ≤95%RH (none compensation)	
Storage environment	Temp: (-10~60) °C ; Humidity: ≤95%RH (None compensation)	
Cable length	Standard 10m (standard) ; can be customized 1~600m (appointment)	
Communication protocol	RS485 communication (standard Modbus-RTU protocol)	
Power supply	DC (9~28) V	
Consumption	<2W	
Difference		
Body material	Engineer plastic	316L
Pressure	0.2 MPa	0.5 MPa
water flow rate	<0.5m/s	<3m/s
Weight	1.5 kg	3 kg
Application	Water body with small fluctuation and less particles and impurities, such as lake and well water	In the water with fast flow rate, large lateral shear force and more particles and impurities, such as: drainage inlet and outlet or liquid level drop is large
Installation method	Vertical installation	Horizontal/Vertical installation

VI. Dimension and wiring connection

① Outer dimension

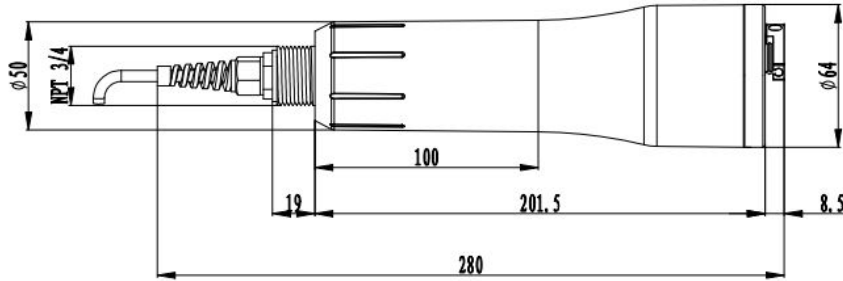

6.1 Dimension (unit: mm)

② Wiring connection

1. Cable

In order to obtain longer distance transmission and environmental tolerance, the cross-sectional area of the power cord used in this data acquisition terminal is slightly larger. Therefore, it is not recommended that customers replace other specifications of commercial cables in order to avoid affecting transmission characteristics. It is recommended to reserve a relatively rich length or original factory cable when purchasing products。

2. Transmission Distance

Data acquisition terminals with different attributes have different maximum limits, and the length supported by different supply voltages is different. Please calculate the maximum distribution distance according to the table below.

Input voltage	Loop current	Maximum loop resistance	Maximum length of cable
24V	40mA	120 Ω	600m
12V	100mA	20 Ω	100m

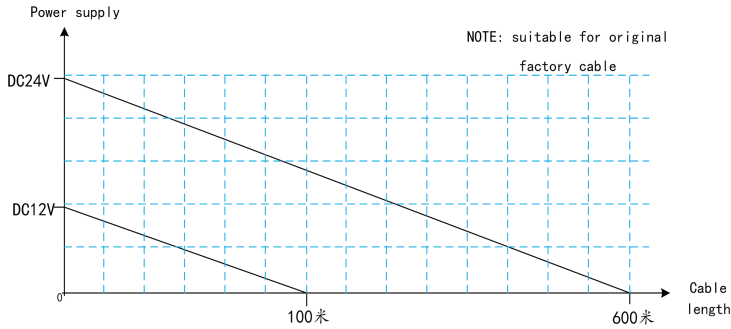

6.2 Diagram of power supply and cable length

3. Wiring connection



6.3 Diagram of wiring connection

Note: DC 24V connection is automatic default regardless of positive and negative, non-polar, power supply range: 9-28V.

③ Communication setting

1. Address and speed: Default baud rate: 9600;Mailing address: 01
2. Batch setting, Factory provides product calibration and hand operator for batch setting, you can be set through the APP;If you have already set the address and speed, you can find the current address and redefine the new address and speed in the APP.
3. To use the hand operator, connect the four wires at the end of the cable to the hand operator, scan the QR code on the hand operator, download a program from the cloud, and turn on the hand operator to complete address modification or product calibration and other work.

4. Offline setup and operation

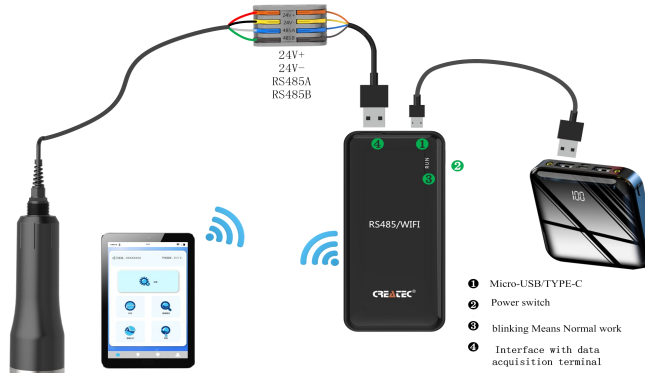

6.4 Offline setting diagram

VII. Installation and maintenance instructions

1) Installation method



7.1 Environmental protection bracket installation

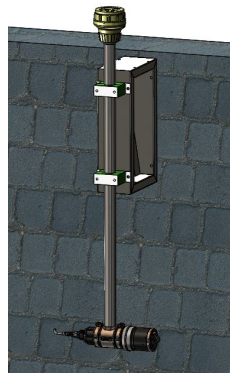

7.2 Horizontal bracket installation

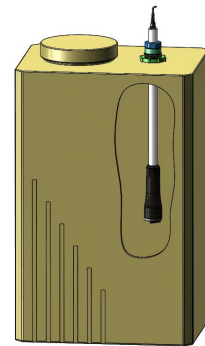

7.3 Through-plate installation

1. Environmental protection bracket installation

It is universally applicable to the support and installation of collection terminals of environmentally friendly sewage treatment plants and other pools or open channels and aquaculture ponds. It is convenient for on-site maintenance. It is an innovative installation method that is safe, convenient, compatible, hygienic and civilized.

When the high turbidity data acquisition terminal is installed vertically, it can be equipped with a multi-degree-of-freedom environmental protection bracket or a floating environmental protection bracket .

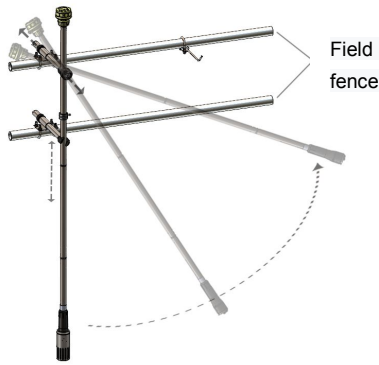

7.4 Vertical installation



7.5 Horizontal installation

2. Horizontal bracket installation

When facing a water body with a fast water velocity, a large lateral shear force and a lot of particles and impurities, For example: when the drain inlet, outlet or liquid level has a large drop, it is recommended that customers choose TUR-6214 high turbidity data acquisition terminal (stainless steel), At the same time, supporting pole-type (Horizontal) mounting bracket can effectively solve the problem of on-site swing.

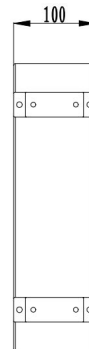
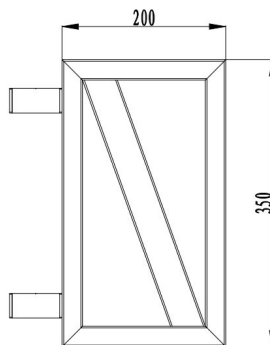
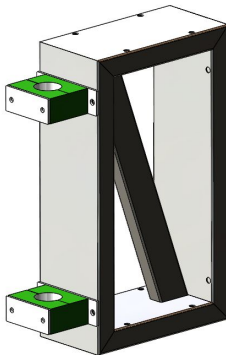

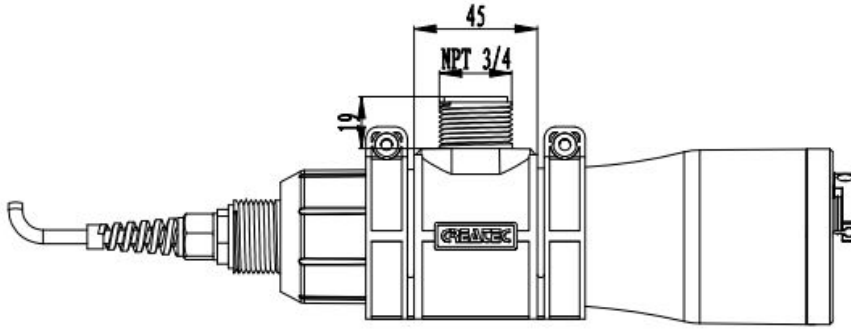

7.6 Support rod type (Horizontal) installation connector size (unit: mm)



7.7 Support rod type (Horizontal) installation component

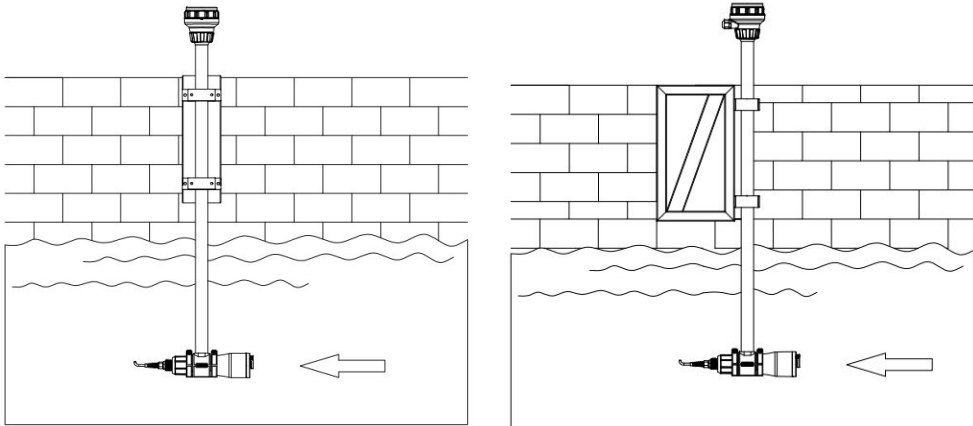

Figure 7.8 Support rod type (Horizontal) installation effect

In some application scenarios where there are more floating objects in aquatic plants or in the rainy season, a protective fence should be installed in front of the collection terminal to create a smooth flow condition for it. At this time, a jacket device with a sieve not only obtains a smooth The water flow will also block some larger particles and fibers from obstructing the sensor, ensuring the stability of its

measurement.



7.9 Protection grid installation component

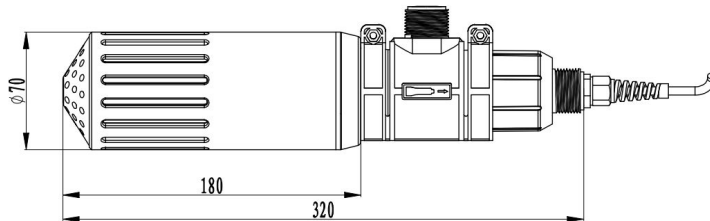

7.10 Protection grid installation component size

3. Through-plate installation

In the integrated environmental protection monitoring station system that uses pumped water sources, the water sample is drained to the test tank. At this time, the through plate installation can be used for easier management and maintenance. The distance between the acquisition terminal and the side wall and the bottom of the measuring tank is detailed in Precautions for installation and maintenance.

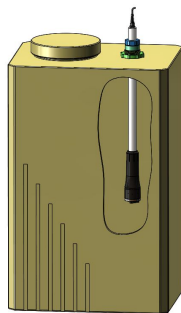
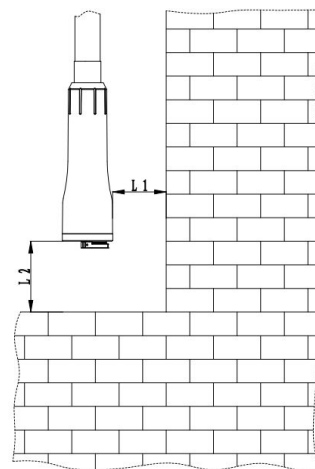

Figure 7.11 Through-plate installation

4. Precautions for installation and



maintenance

- (1) Air bubbles at the installation site will inevitably cause measurement errors. It is recommended to add air bubble elimination and shielding devices;
- (2) When installed upright, the lower part of the optical inspection needs to keep a large distance from the bottom, side or objects to reduce the deviation caused by reflected light;
- (3) During installation, there is no obstacle within L2 at least 20 cm in front of the TUR/TSS-6200 optical window. At the same time, to prevent the bottom sludge from settling and the interface rises, it is necessary to reserve the bottom sludge deposition space;
- (4) The distance L1 between the side wall of the turbidity data collection terminal and the periphery of the measurement environment should be greater than 20cm;
- (5) When installed horizontally, the optical surface faces the direction of the water flow to avoid vortex turbulence and bubbles on the measurement end surface when facing backwards, which may cause unstable measurement values;
- (6) When installing the turbidity data collection terminal, keep it away from large objects (Such as branches, ice, underwater protrusions) to prevent interference from light reflection;
- (7) When installing the turbidity/suspended Solid data acquisition terminal , the optical window should avoid the surface of the object with strong reflection;
- (8) If you choose horizontal installation, you need to ensure that the operation of the data acquisition terminal is always in a fully submerged state;
- (9) When installing vertically in the sewage tank, avoid the rise of the sludge interface and bury the TUR/TSS measuring end in the activated sludge or sediment;
- (10) Turbidity data acquisition terminal is not recommended to be installed in fluid pipelines with pressure changes; if you must use it in fluid pipelines, you can choose our company's TUR-6314 high turbidity data acquisition terminal.



5. Wireless remote connection

In construction sites that are blocked by rivers, ponds, and buildings, where bridges, pipes, and wiring cannot be erected, you can purchase our company's LORA or Zigbee or WIFI wireless modules to achieve remote wireless transmission. This is favored by user engineers in scenarios such as environmental monitoring, sewage treatment plants, aquaculture farms, and subsequent expansion of factories because of the convenience of networking.

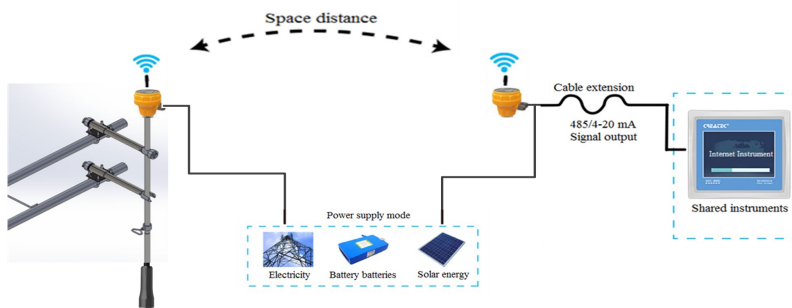

7.12 Schematic diagram of wireless remote connection

Note: WiFi-short-range communication only under barrier-free barriers;
 LORA——Long-distance (about 10Km) communication without obstacles;
 Zigbee-when encountering obstacles, it is composed of multiple relay relays to avoid obstacles.

6. Data bus application



Figure 7.13 Field data bus serial application

In the industrial site, the original cable is used to meet a variety of serial power distribution, reducing on-site construction and maintenance costs.

2) Calibration of data collection terminal

The TUR-6200 high turbidity data acquisition terminal has been calibrated when it leaves the factory. If you need on-site inspection or verify whether it is accurate after a period of use, you can calibrate the collection terminal. The instrument has two calibration methods:

1. The turbidity data acquisition terminal (without its own display instrument) directly outputs RS485 digital signals. The digital interface can be directly matched to display with industrial computer, configuration display, PLC, RS485 communication port instrument, and use our company's digital TUR/TSS-6000 high turbidity/suspended matter upper computer software setting on the man-machine interface of the above equipment. And calibration software to set up

and calibrate the instrument.

2. You can use the company's data acquisition terminal handheld operator to complete the setting operation under the APP, and scans the QR code on the handheld operator to download the application applet; Scan the QR code on the turbidity product to download the calibration program, and complete the calibration check and other corresponding settings according to the operation steps under the APP interface.

3. It can also be connected to the computer installed with the upper computer software of the turbidity online analyzer through the RS485/RS232 or USB port converter to complete the calibration and calibration together with the computer interface .

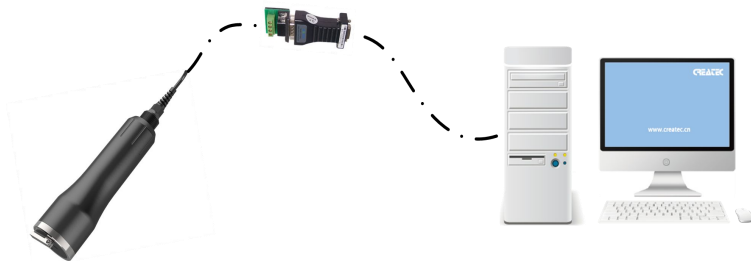

The communication protocol and calibration software of the upper computer can be registered and downloaded on our website.

① Upper computer software login interface

The customer login password is: 0000. Click Login to enter the next interface.

② Upper computer software communication setting interface

③ Turbidity Calibration

Turbidity calibration requires the instrument to be calibrated with 800 NTU turbidity standard solution. When the customer's field conditions permit,

it is recommended to use deionized water for zero calibration of the instrument.

If the instrument needs slope calibration, you can consult our company in advance to order the required turbidity standard solution;

800NTU turbidity standard solution is recommended to be used on the spot, not recommended for long storage,

If the customer has the conditions and ability to prepare the turbidity standard solution on site or in the laboratory, the turbidity correction solution can be configured according to the following methods.

The configuration method of 800NTU turbidity standard solution is as follows:

a. Configure pure water with turbidity of 0 NTU

Distilled water is filtered through a 0.2um membrane filter to obtain a zero NTU solution.

b. Hydrazine sulfate solution

Weigh 1.0 g of hydrazine sulfate (also known as hydrazine sulfate), dissolve in pure water, and dilute the volume in an 80 mL volumetric flask.

c. Hexamethyltetramine solution

Weigh 10.0g of hexamethyltetramine, dissolve it in pure water, and dilute

it in an 80mL volumetric flask.

d. Formazin turbidity standard solution

Draw 80.0 mL of hydrazine sulfate solution respectively, Add 80.0 mL of hexamethyltetramine solution to a constant volume in a 200ml volumetric flask, mix well, When placed at $25\pm 3^{\circ}\text{C}$ and protected from light for 24 hours, the turbidity of this standard solution is 4000NTU.

e. 800 NTU Formazin Turbidity Standard Solution

Draw 200mL of 4000NTU formazin standard mixture and place it in a 1000ml volumetric flask. Add pure water to the mark and mix well. This standard solution is 800NTU turbidity standard solution.

④ **Zero Calibration:**

Wash calibration measuring cylinder (diameter of about 10 to 12 cm, height of about 20 cm) twice with deionized water, put the turbidity/suspended analyzer in the deionized water of measuring cylinder (liquid level height 10 cm), and use tools fixed turbidity/suspended online analyzer, the tip of the probe should be under the surface (2-3)cm (1 inch); When the reading is stable, click the zero point to calibrate;

Slope calibration: Wash and dry the measuring cylinder with deionized water twice; Gently invert the 800NTU standard solution bottle at least 50 times, mix the standard solution evenly, and pour a small amount of the standard solution into the calibration cylinder for wet washing. Slowly (to avoid bubbles) pour the standard solution from the bottle into the calibration cylinder (to ensure the level is about 10cm); Immediately put the probe into the

calibration measuring cylinder; Using a tool to fix the turbidity/suspended matter on-line analyzer, the top of the probe should be approximately (2-3)cm (1 inch) below the surface of the water; Wait for the measured value of turbidity/suspended matter online analyzer to be stable, then click the slope calibration and input the value of standard solution 800NTU to correct the slope of turbidity/suspended matter online analyzer;

3) Applications

A. municipal water and industrial sewage treatment process

- Water supply plant

Filter backwash turbidity monitoring, cleaning water turbidity control

- Surface water

On-line Turbidity Monitoring and Analysis of Water Quality in Environmental Monitoring Station

- Sewage treatment plant

Monitoring of various process stages such as water inlet and outlet, aeration tank, return sludge, primary sedimentation tank, secondary sedimentation tank, thickening tank, sludge dewatering, etc.

B. Online turbidity analysis of industrial wastewater discharge and industrial wastewater recycling and reuse treatment process points

- Paper mill

Pulp concentration

- Coal washing plant

Sedimentation tank, concentration tank

- Electricity

Mortar sedimentation tank, power plant desulfurization lime slurry

C. Other industry

PCB industry sandblasting liquid and biogas slurry tank (biogas power

generation)

VIII. Daily maintenance and precautions of the sensor

(1) Maintenance plan

Maintenance task	Visual inspection	Maintenance content
Maintenance frequency	Every month	Remove the attached debris on the surface and wipe the attached matter on the end surface
Wiper strip	Every 6 months (depending on environmental conditions)	When the window surface is not completely wiped, replace the wiper strip

(2) Cleaning the measurement window

① The measuring window is made of coated optical quartz glass, When maintaining, you can choose to clean with neutral detergent and eye cloth or lens test paper. Damage to the measurement window will directly cause damage to accuracy, Scratches on the coated glass will cause interference of stray wavelengths and affect measurement accuracy.

② For the insoluble precipitates on the optical glass, It is recommended to use a neutral cleaning liquid Wash, such as: detergent, etc.

IX. Product completeness

(1) Standard package

TUR-6200 Turbidity Data Acquisition Terminal

Order number	Name	Specification model	Unit	Picture
248782	High Range Turbidity data acquisition terminal	TUR-6204	Set	A black, cylindrical handheld device with a sensor tip at the end.
248783	High Range Turbidity data acquisition terminal	TUR-6214	set	A silver, cylindrical handheld device with a sensor tip at the end.
	Instruction	TUR-6200	pc	A blue and white document cover with the CREATEC logo and Chinese text.
	Certification	TUR-6200	pc	A blue and white document with the CREATEC logo, Chinese text, and a red triangle warning symbol.

(2)Communication conversion accessories (optional)

Order number	Name	Specification model	Unit	Picture

TUR-6200 Turbidity Data Acquisition Terminal

248764	RS485/4-20mA Conversion module	CEM-6232	set	 <p>For integrated use inside the chassis</p>
	RS485/RS232 converter	CEM-6120	set	
	RS485/CAN converter	CEM-6251	set	
	RS485/Lora converter	CEM-6362	set	 <p>For outdoor waterproof installation</p>
	RS485/ZigBee converter	CEM-6372	set	
	RS485/ Optical converter	CEM-6280	set	<p>For integrated use inside the chassis</p> 
	RS485/Ethernet converter	CEM-6290	set	 <p>For integrated use inside the chassis</p>



TUR-6200 Turbidity Data Acquisition Terminal

	RS485/HART converter	CEM-62A0	set	 <p>For integrated use inside the chassis</p>
	RS485/ Infrared communication converter	CEM-62C0	set	 <p>For integrated use inside the chassis</p>
	modbus/profibus converter	CEM-62B0	set	 <p>For integrated use inside the chassis</p>
248778	Hand-held RS485/WIFI Operator	CEM-6100	set	 <p>Portable</p>



(3)Display unit (optional)

Order number	Name	Specification model	Unit	Picture
510054	Universal multi-function controller (Wall-mounted)	MCC-2300	set	

TUR-6200 Turbidity Data Acquisition Terminal

242010	Universal multi-channel controller (Panel type)	MFC-1380 (138*138)	set	
242009	Universal multi-channel controller (Sealed)	MFC-1200	set	
248769	IoT instrument	MFC-8800 (96*96)	set	

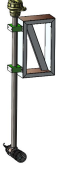
(4)Product Installation accessories (optional)

Order number	Name	Specification model	Unit	Picture
1051034	Environmental protection sensor bracket	ESB-100-PP-DN2 5	set	
	Environmental protection sensor (reinforced) bracket		set	
	Support rod lateral installation accessories			

(5)calibration accessories (optional)

Order number	Name	Specification model	Unit	Picture
	Standard solution	80NTU	500mL/bottle	

(6)Connector (optional)

Order number	Name	Specification model	Unit	Picture
112031814	Bus waterproof splitter	M20T-Tee-4 core	pc	

X. Appendix 1: RS485-Modbus

Register number	symbol	Parameter	Address	Type	Value range	Remark	
40001		Instrument model letter	0	Readable	0-16	9:means TUR	
40002		Instrument model number	1		0-65535	6200	
40003		Main measurement 1 (Tur)	2		32-bit integer	High eight decimal	Turbidity measurement value
40004			3				
40005		Unit and decimal point	4			0x00xx: no decimal, 0x01xx: one digit	

TUR-6200 Turbidity Data Acquisition Terminal

					places Low eight unit	0x02xx: two digits, 0x03xx: three digits Refer to the attached table for unit representation
40006		Scratch state	5		16-bit integer	Scraper operation status 0xFF: scraping 0xFE: Scrape failure Other: Scratch successfully
40007- 40014		Reserved	6- 13			
40015		Temperature	14		16-bit integer	Unit: °C, fixed to one decimal place.
40016		Cavity Humidity	15		16-bit integer	fixed to one decimal place.
40017		Cavity temperature	16		16-bit integer	Unit: °C, fixed to one decimal place.
40018- 40020		Reserved	17-1 9			
40021		Task selection	20	Rea dabl e Writ able	16-bit integer (0-3)	0: Main measurement 1: Electronic calibration 2: Calibration of turbidity standard solution 3: Calibration of suspended solids User calibration process see attached picture
40022		Electronic zero result	21		16-bit integer	0: No calibration this time 1: Successful calibration 2: Calibration failed
40023		Standard solution (800NTU) calibration result	22		16-bit integer	0: No calibration this time 1: Successful calibration 2: Calibration failed
40024		Standard liquid actual value setting	23		16-bit integer 0-40000	Enter the actual value of the standard solution,Fixed one decimal place,Value range: 0.0-4000.0NTU.Then input the start calibration mark after the

TUR-6200 Turbidity Data Acquisition Terminal

					standard solution measurement value is stable. Standard solution calibration is performed immediately after the instrument detects the start calibration mark Default is 8000
40025		Suspended solids calibration results	24	16-bit integer	0: No calibration this time 1: Successful calibration 2: Calibration failed
40026		Number of calibration points	25	16-bit integer	1: Single point 2: Two points 3: Three points 4: Four points 5: Five points Default :1
40027		First point Measured value	26	16-bit integer	Fixed three decimal places
40028		First point Actual value	27	16-bit integer (0-50000)	Fixed three decimal places (magnification 1000 times)
40029		Second point Measured value	28	16-bit integer	Fixed three decimal places
40030		Second point Actual value	29	16-bit integer (0-50000)	Fixed three decimal places (magnification 1000 times)
40031		Third point Measured value	30	16-bit integer	Fixed three decimal places
40032		Third point Actual value	31	16-bit integer (0-50000)	Fixed three decimal places (magnification 1000 times)
40033		Fourth point Measured value	32	16-bit integer	Fixed three decimal places
40034		Fourth point Actual value	33	16-bit integer (0-50000)	Fixed three decimal places (magnification 1000 times)
40035		Fifth point Measured value	34	16-bit integer	Fixed three decimal places
40036		Fifth point Actual value	35	16-bit integer (0-50000)	Fixed three decimal places (magnification 1000 times)
40044-40049		Reserved	43-48		Reserved
40050		Measurement	49	16-bit integer	MSB: 1: Turbidity 2: Suspended

TUR-6200 Turbidity Data Acquisition Terminal

		parameter options				solids
40051		Engineering unit options	50		16-bit integer	When turbidity: 1: NTU 2: FNU When suspended solids: 1:mg/L, 2:g/L
40052		Scrape once	51		16-bit integer	1: Scrape for one operation, 0: no action
40053		Cleaning interval	52		16-bit integer (5-1440)	5min-24h (0 is to close the hanging brush) Default 15min
40054		Scratch state	53		16-bit integer	0xFF cleaning 0xFE Scratch failure Other: Scratch successfully
40055		Reserved	54		16-bit integer	
40056		Turbidity (or suspended solids) migration	55		16-bit integer (0-60000)	Fixed three decimal places Turbidity range: 0-60.000NTU Suspended matter range: 0-50g/L
40057		Turbidity (or suspended solids) migration symbol	56		16-bit integer	1:+ 2:-
40058		Reset	57		16-bit integer	1:Reset
40100		Baud rate	99		16-bit integer	1:1200,2:2400,3:4800, 4:9600 Default :4
40101		Address	100		16-bit integer	1-247 Default :1

Unit function code Appendix

Read value	00	01	02	03	04	05	06	07
unit	无	μS/cm	mS/cm	MΩ·cm	mV	V	mg/L	g/L
Read value	08	09	0A	0B	0C	0D	0E	0F
unit	%	°C	°F	Hz	m/h	m³/s	m³	m³/h
Read value	10	11	12	13	14	15	16	17

TUR-6200 Turbidity Data Acquisition Terminal

unit	ppm	ppt	m/s	L	mA	mbar	NTU	FNU
Read value	18	19	1A	1B	1C	1D	1E	1F
unit	s	GPM	Gal	Pluse/min	mm	%	pH (Non-unit)	h
Read value	0x28	29	2A	2B	2C	2D	2E	30
unit	g/L							